

17 Brickfield Court
Slough

Guide Price £150,000 Leasehold

17 Brickfield Court,
5 Bath Road, Slough
Berkshire SL1 3FX

£150,000 Leasehold

“Modern first floor bedroom apartment with underground parking”

A well presented modern one bedroom apartment situated in a convenient town centre location and within walking distance to the mainline railway station. The property benefits from secure underground parking, access to gymnasium, concierge service and has a long lease. NO ONWARD CHAIN

OPEN PLAN LIVING ROOM/KITCHEN: DOUBLE BEDROOM: BATHROOM: ALLOCATED UNDERGROUND PARKING: CONCIERGE SERVICE: GYM FACILITY: VIDEO ENTRY PHONE: ELECTRIC HEATING.

EPC RATING: C

Lease length: 992 years
Ground rent: £185 pa
Service charge: £1,283.21 half yearly

358 sq.ft. (33.2 sq.m.) approx.

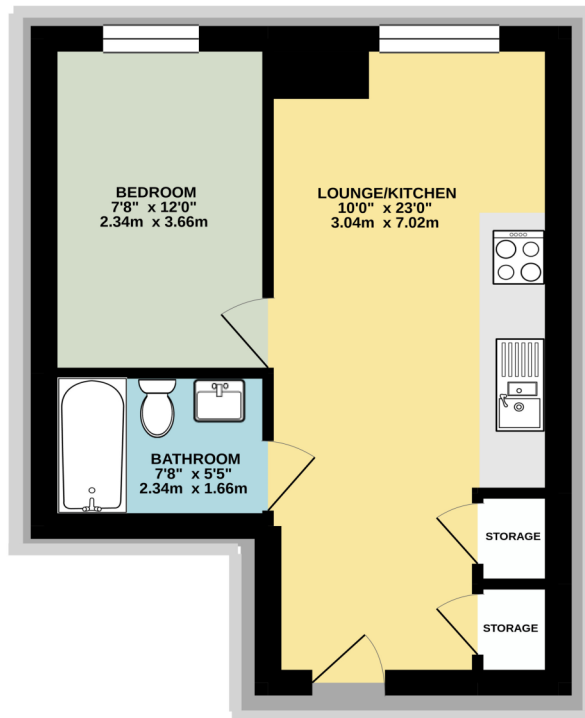

TOTAL FLOOR AREA : 358 sq.ft. (33.2 sq.m.) approx.

Whilst every attempt has been made to ensure the accuracy of the floorplan contained here, measurements of doors, windows, rooms and any other items are approximate and no responsibility is taken for any error, omission or mis-statement. This plan is for illustrative purposes only and should be used as such by any prospective purchaser. The services, systems and appliances shown have not been tested and no guarantee as to their operability or efficiency can be given.
Made with Metropix ©2020



■ AUCTIONEERS ■
■ SURVEYORS ■
PIKE
SMITH
KEMP
■ ESTATE AGENTS ■
■ VALUERS ■





PIKE SMITH & KEMP

22 QUEEN STREET, MAIDENHEAD, BERKSHIRE SL6 1HZ

MAIDENHEAD@PIKESMITHKEMP.CO.UK

Tel: 01628 621177